

REVISIONS			
REV.	DESCRIPTION	DATE	APPROVED
A	INITIAL RELEASE	3/11/2014	

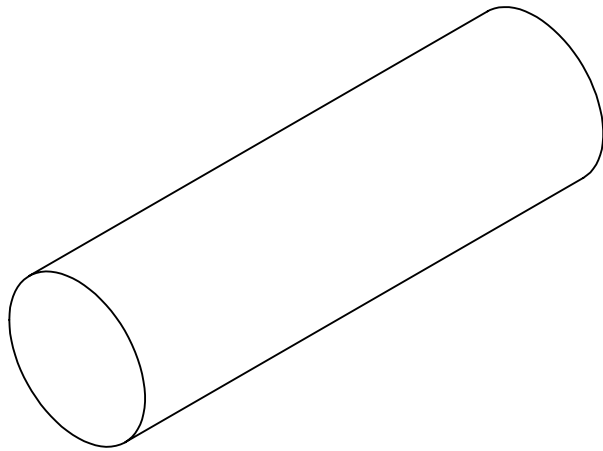

RE-PN-1X338
ARM ROD END 50 SERIES, PRE 2014 TORSION BAR
0.75 LBS

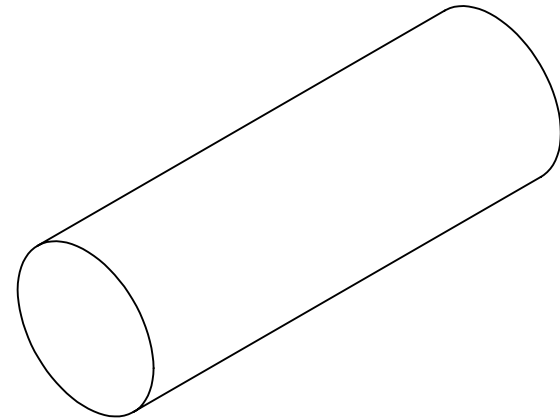
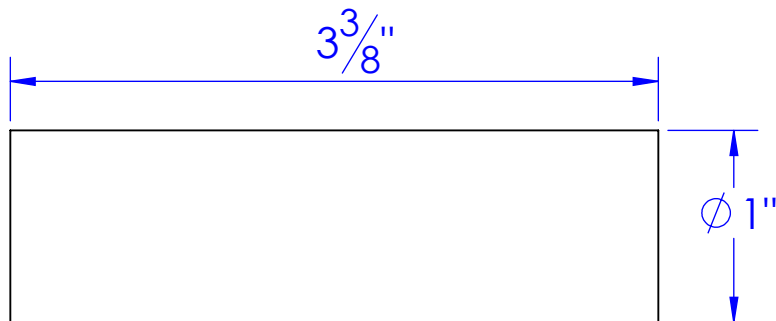

RE-PN-1X301
ARM ROD END 50 SERIES, 2014 TORSION BAR
0.67 LBS

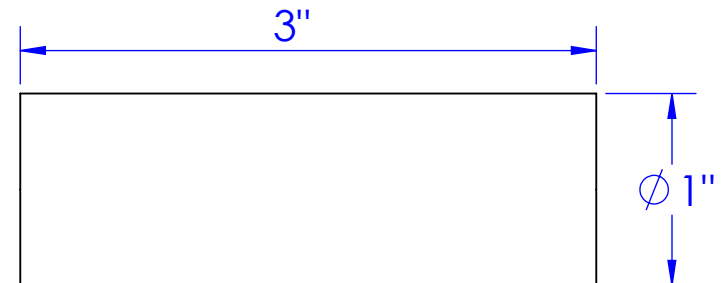

PROPRIETARY AND CONFIDENTIAL
 THE INFORMATION CONTAINED IN THIS
 DRAWING IS THE SOLE PROPERTY OF TRIPLE
 C INC. ANY REPRODUCTION IN PART OR
 AS A WHOLE WITHOUT THE WRITTEN
 PERMISSION OF TRIPLE C INC. IS PROHIBITED.

DIMENSIONS ARE IN INCHES TOLERANCES: FRACTIONAL $\pm 1/16$ ANGULAR: MACH ± 1 BEND \pm TWO PLACE DECIMAL ± 010 THREE PLACE DECIMAL ± 005			NAME	DATE
		DRAWN	HEATH	3/11/2014
		PART #		
		ASM #	SEE DWG	
MATERIAL --		COMMENTS: ARM ROD END 50 SERIES PINS		
DO NOT SCALE DRAWING				

P.O. BOX 248, SABETHA, KS 66534			
TRIPLE C INC.			
SIZE A	DWG. NO. 10-1714	REV. A	
SCALE:1:1	WEIGHT: --	SHEET 1 OF 1	